

RWY	BRG MAG	THR	BEARING	STRENGTH – SURFACE
12	117°	444935N 0201727E	3000 M 400 M	PCN 72/F/C/X/U – ASPH PCN 61/R/B/X/U – CONC
30	297°	444844N 0201923E	400 M 3000 M	PCN 61/R/B/X/U – CONC PCN 72/F/C/X/U – ASPH
APRON A		ACFT stand A1 ACFT stands A2, A3, A10 ACFT stands A4-A9 ACFT stands A11-A14		PCN 49/R/B/X/U – CONC PCN 49/R/B/X/U – ASPH PCN 51/R/C/X/U – CONC PCN 49/R/B/X/U – ASPH
APRON B				PCN 61/R/B/X/U – CONC
APRON C				PCN 61/R/B/X/U – CONC
APRON E				PCN 74/R/C/W/T – CONC
APRON N				PCN 76/R/C/W/U – CONC
TWY A		width 23 M		PCN 53/R/A/X/U – ASPH
TWY B		width 23 M		PCN 53/R/A/X/U – ASPH
TWY C		width 23 M		PCN 73/R/C/X/U – ASPH
TWY D		width 23 M		PCN 61/R/B/X/U – ASPH
TWY E		width 23 M		PCN 53/R/A/X/U – ASPH
TWY F				PCN 61/R/B/X/U – CONC
TWY G		ACFT stands A1-A9 ACFT stands A10-A14		PCN 61/R/B/X/U – CONC PCN 61/R/B/X/U – ASPH
TWY H				PCN 73/R/C/X/U – CONC
TWY J				PCN 73/R/C/X/U – CONC
TWY K				PCN 61/R/B/X/U – CONC
TWY L				PCN 73/R/C/X/U – CONC
TWY M				PCN 61/R/B/X/U – CONC

COORDINATES FOR RWY EXIT LINE NOT AVBL
COORDINATES FOR TWY CENTRE LINES NOT AVBL
OBSTACLES TO TAXIING NOT AVBL

Hot spot 1 and 2

This is a high volume intersection for all traffic taxiing from departure and arrival RWY 12/30. Vehicles also crossing in this area.

Hot spot 3

This is high volume intersections for taxiing aircraft. A service road crossing TWY L Hot spot area with potential of incidents between ground service equipment and towed aircraft or aircraft exiting parking stand B10. Pilots are to exercise caution.

TAXIING RESTRICTIONS:

- TWY E:**
Left turn from RWY 30 to TWY E is permitted to aircraft with outer main gear wheel span up to 9.00 M.
Right turn from RWY 12 to TWY E: no restriction
- TWY D:**
Left turn from RWY 30 to TWY D is not permitted.
Right turn from RWY 12 to TWY D: no restriction.

NOTE:
TWY F, G, H, J, K, L and M are aircraft stand taxiways.

TURN PAD RESTRICTIONS:

- Turns on turn pad on the end of RWY 12 limited to ACFT with: wingspan up to 44.84 M, wheel base up to 18.60 M and main gear wheel span up to 10.93 M.
- Turn pad not to be used during night and in low visibility conditions.

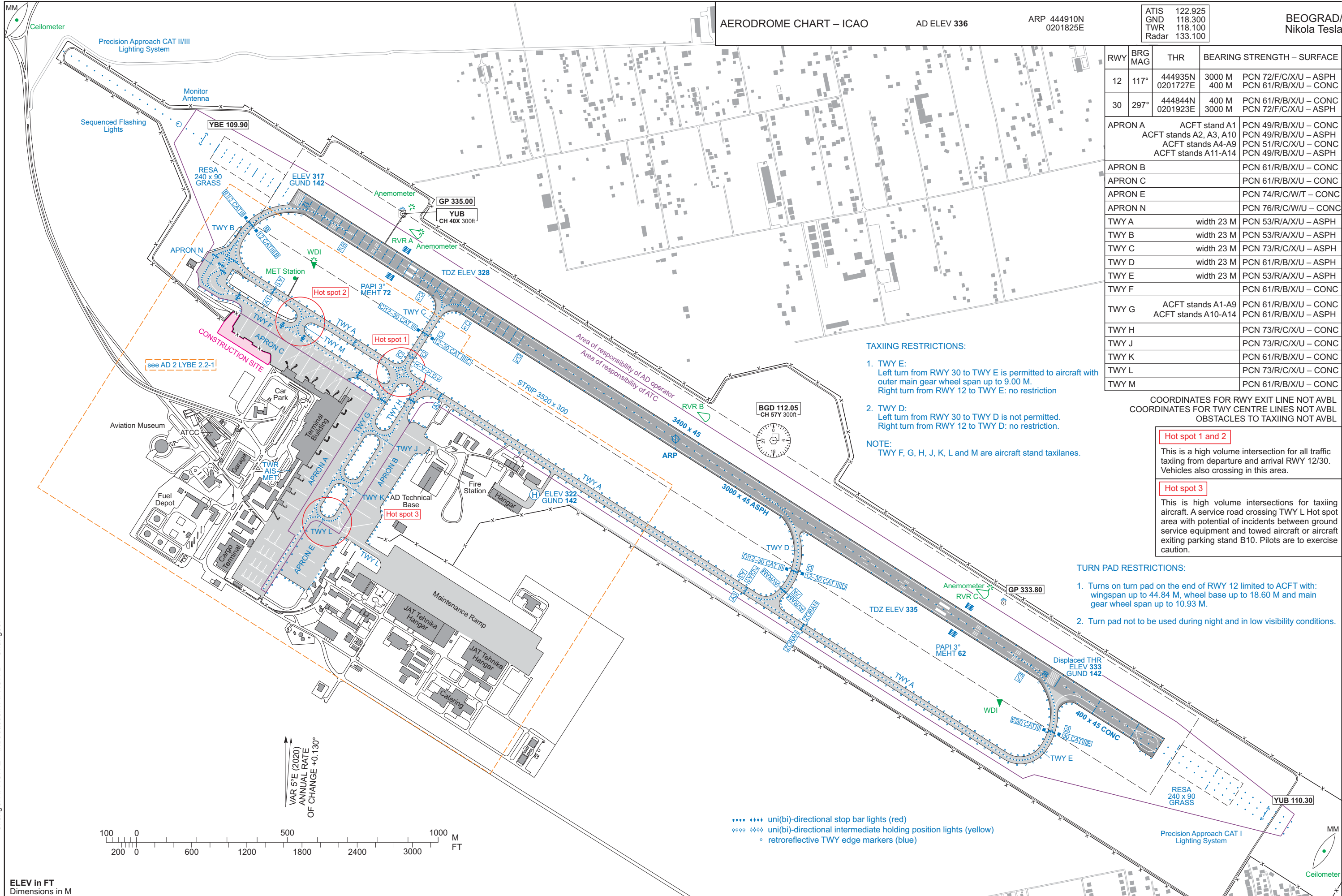

Change: APRON E – Introduction. APRON B – Changes.

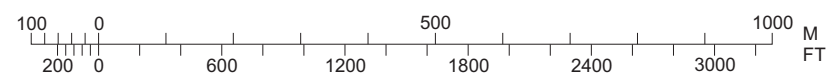

●●●● uni-(bi)-directional stop bar lights (red)
 ○○○○ uni-(bi)-directional intermediate holding position lights (yellow)
 ○ retroreflective TWY edge markers (blue)

ELEV in FT
Dimensions in M

NAMERNO OSTAVLJENA PRAZNA STRANA
INTENTIONALLY LEFT BLANK